

FOR  
LEASE

# RIVERPOINT OFFICE/FLEX

475 SW 5TH STREET, DES MOINES, IOWA



FOR MORE  
INFORMATION  
PLEASE CONTACT

**Paul Weeks**  
Vice President  
Broker Associate  
515.221.6691  
paul.weeks@cbre.com

**CBRE/Hubbell Commercial**  
6900 Westown Parkway  
West Des Moines, IA 50266

[www.cbrehc.com](http://www.cbrehc.com)

LISTING # 1274358

## PREMISES:

- Entire building of 25,000 SF

**LEASE RATE:** \$4.25/SF Net

## FEATURES:

- 100% finished, open plan office
- Convenient downtown location just south of Martin Luther King extension
- Free, on-site parking
- Located on city bus route
- High ceilings
- Dock high loading capability
- Landlord will amortize Tenant Improvements
- Professionally managed by Hubbell Realty Company



**SEE FLOOR PLAN ON REVERSE SIDE**

Owned & Professionally Managed by:



Always Breaking New Ground!



Part of the CBRE affiliate network

FOR  
LEASE

# RIVERPOINT OFFICE/FLEX

475 SW 5TH STREET, DES MOINES, IOWA

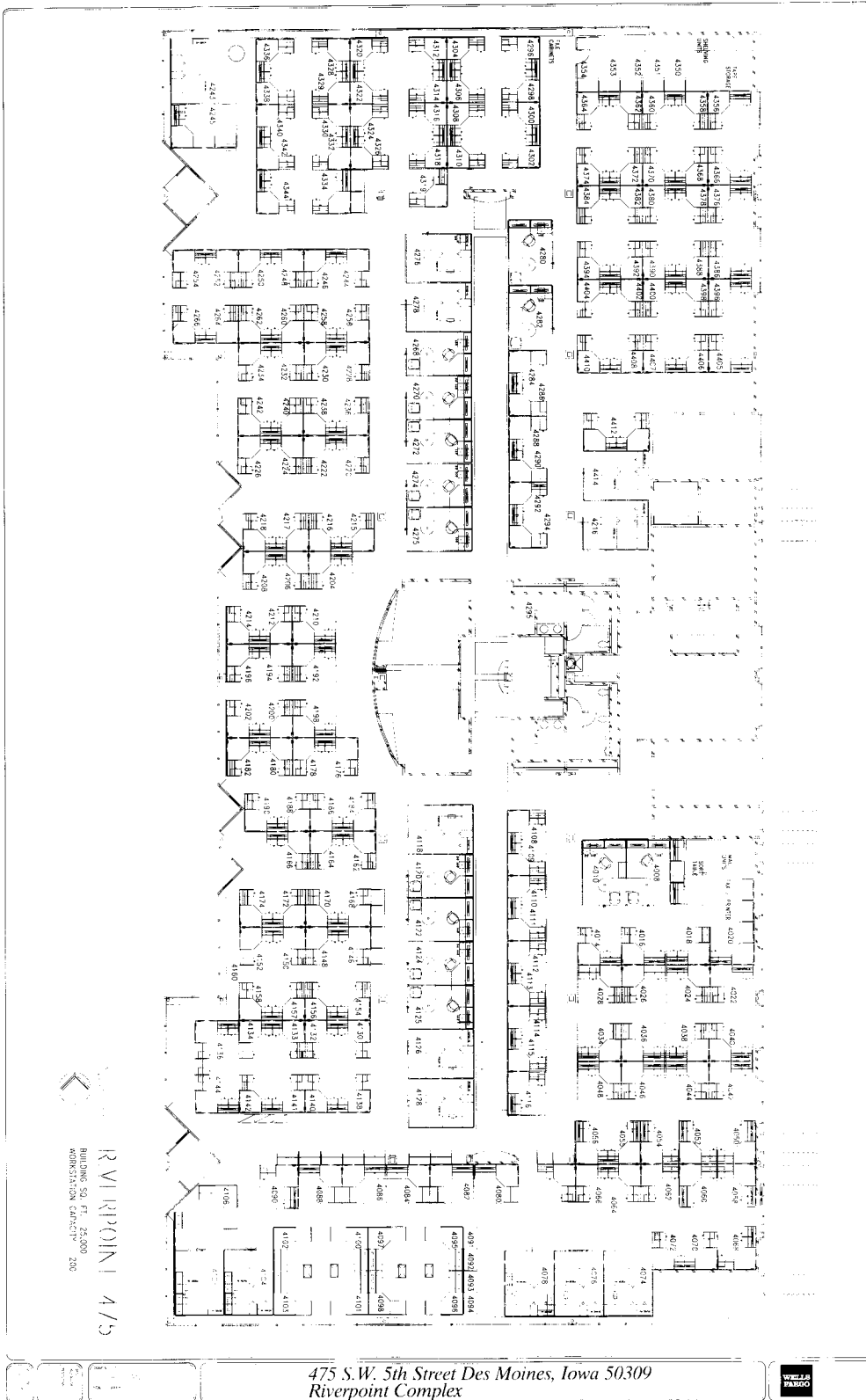

2012 © Hubbell Commercial Brokers, L.C., d/b/a CBRE/Hubbell Commercial. We obtained the information above from sources we believe to be reliable. However, we have not verified its accuracy and make no guarantee, warranty or representation about it. It is submitted subject to the possibility of errors, omissions, change of price, rental or other conditions, prior sale, lease or financing, or withdraw without notice. We include projections, opinions, assumptions or estimates for example only, and they may not represent current or future performance of the property. You and your tax and legal advisors should conduct your own investigation of the property and transaction.

**CBRE** | Hubbell  
Commercial  
Part of the CBRE affiliate network