

FOR  
LEASE

# LAKEVIEW MEDICAL PARK OFFICE

SUITE 300, 6000 UNIVERSITY AVENUE, WEST DES MOINES, IOWA

Medical Office space  
available in the heart of  
West Des Moines' "Medical  
Mile"



FOR MORE  
INFORMATION  
PLEASE CONTACT

**Paul Weeks**  
Vice President  
Broker Associate  
515.221.6691  
paul.weeks@cbre.com

**CBRE/Hubbell Commercial**  
6900 Westown Parkway  
West Des Moines, IA 50266

[www.cbrehc.com](http://www.cbrehc.com)

LISTING # 1266b

Owned & Professionally Managed by:



Always Breaking New Ground!

## PREMISES:

- 2,629 RSF (Suite 145)
- 4,073 RSF (Suite 300)
- 4,855 RSF (Suite A-15)

**LEASE RATE:** \$14.50/SF Net, plus \$13.73 2012 Operating Expenses, full service

## FEATURES:

- Medical Office Space located in the heart of West Des Moines' "Medical Mile"
- Full service lease rate includes valet parking service, janitorial service, plus all utilities and building services
- Available immediately
- See existing floor plan on reverse side for Suite 300

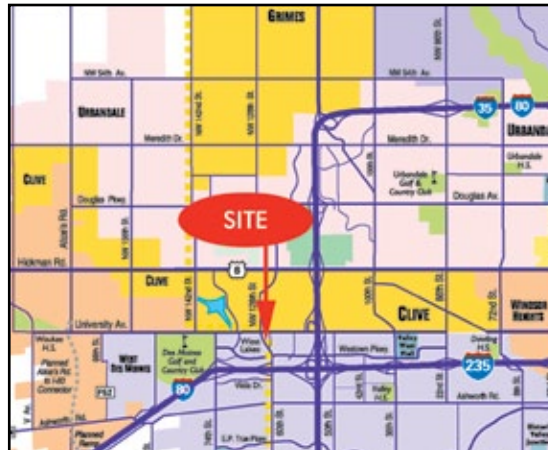

**CBRE** | Hubbell  
Commercial

Part of the CBRE affiliate network

FOR  
LEASE



# LAKEVIEW MEDICAL PARK OFFICE

SUITE 300, 6000 UNIVERSITY AVENUE, WEST DES MOINES, IOWA

## Suite 300

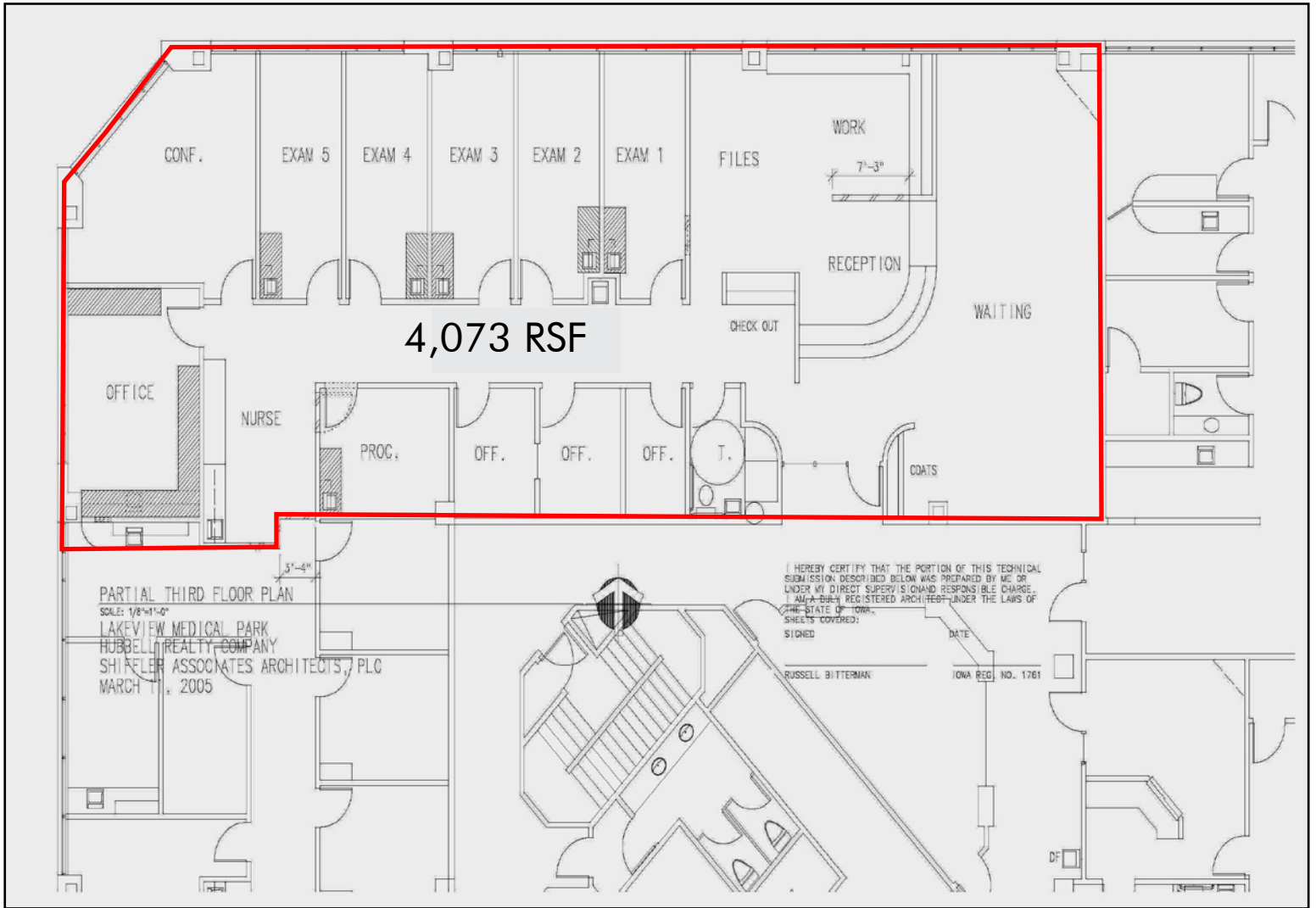

2012 © Hubbell Commercial Brokers, L.C., d/b/a CBRE/Hubbell Commercial. The information above has been obtained from sources believed reliable. While we do not doubt its accuracy, we have not verified it and make no guarantee, warranty or representation about it. It is your responsibility to independently confirm its accuracy and completeness. The value of this transaction to you depends on tax and other factors which should be evaluated by your tax, financial and legal advisors. You and your advisors should conduct a careful, independent investigation of the property to determine to your satisfaction the suitability of the property for your needs.